



DesignSuite

Certified. Compliant. Complete.

The **DesignSuite** range offers a comprehensive portfolio of doors, catering to a variety of project needs. This includes both fire-rated (FD30s & FD60s) and non-fire-rated options. All doors are meticulously crafted with a focus on architectural integration, providing a diverse range of finishes to complement any design intent. Furthermore, the DesignSuite adheres to relevant DDA accessibility recommendations.

Where can DesignSuite be specified?

DesignSuite is commonly specified for commercial, education, healthcare, public buildings and high-end residential developments. Specifiers of this suite often use it as their core range, adding products from our other high performance suites for specialist applications.



DesignSuite Features

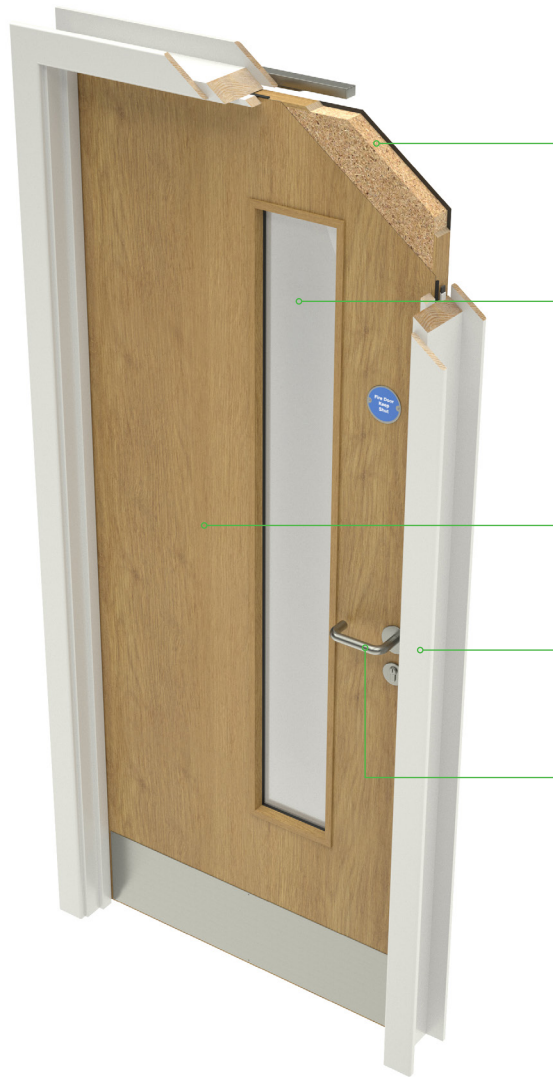

1. **Core** – Range of cores are available to achieve essential fire and acoustic performance ratings, at a base level.
2. **Vision Panel** – Specified in a size and position in accordance with BS 8300 recommendations, with glass to meet fire and acoustic performance requirements. Beading is available in both bolection and flush style.
3. **Finishes** – Laminate, wood veneer, primed and painted finishes available.
4. **Frame** – Options include, but are not limited to, both loose stop and rebated frames.
5. **Ironmongery** – A wide range of ironmongery & access control products in a selection of styles and finishes.
6. **Fire ratings** – From NFR to FD60s
7. **Acoustic ratings** – Up to 35RWdB

Frame Details

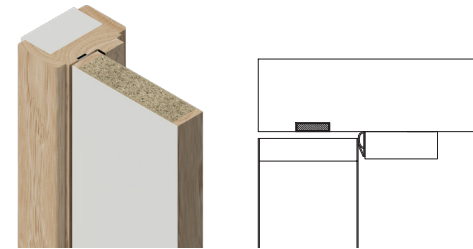

Loose Stop Frame

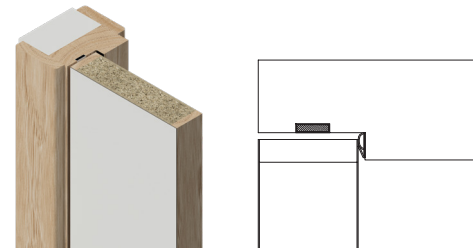

Rebated Frame

Vision Panel Bead Details

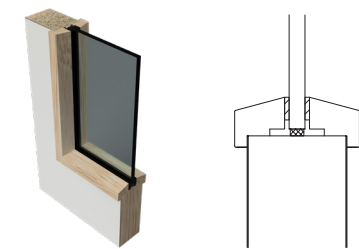

Bolection Bead

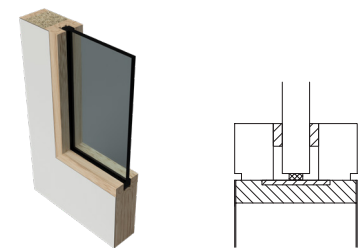

Flush Bead

Core Types

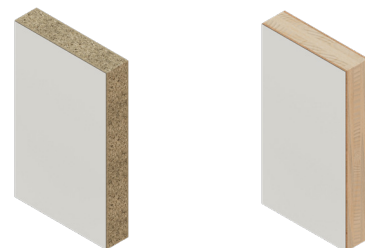

Epicore

Epicore Plus



To view DesignSuite, visit our website here



View us on NBS Source here

Specification Details

Configuration Options

DorSuite's performance doorsets are available in various configurations to meet the needs of any project. They can be single or double doorsets (either equal or leaf & a half pairs), and as single or double swing. All doorset choices include full height doors, with the option of glazed or unglazed overpanels, side lights, or fanlights. Overpanels can be installed with or without a transom.

Single Leaf

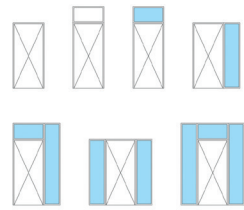
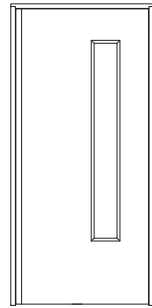

Double Leaf

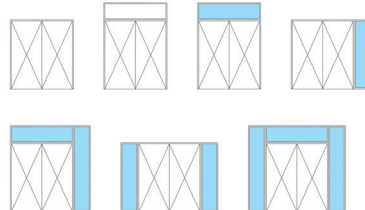
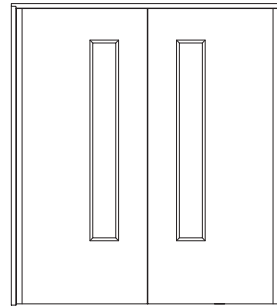

Leaf & a half

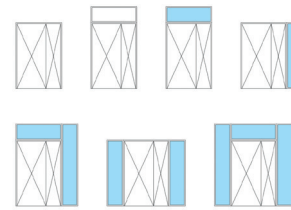
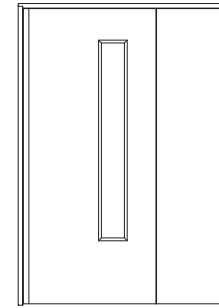

Door Handings

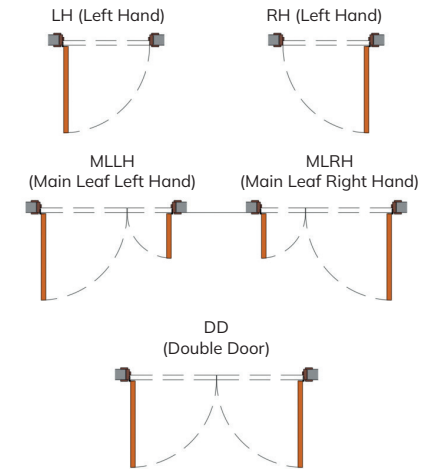

Standard Leaf Size Table

FD30 Sizes

Configuration	FD30 Max door leaf width
Single Leaf - When the door has a latch	1411mm (@2404mm Height)
Single Leaf - Unlatched	1153mm (@2900mm Height)
Double Leaf - When the door has a latch	1181mm (@2404mm Height)x2
Double Leaf - Unlatched	1103mm (@2900mm Height)x2
Door leaf size max width per leaf	FD30 Max door leaf height
Single Leaf - When the door has a latch	3125mm (@1085mm width)
Single Leaf - Unlatched	3145mm (@1050mm width)
Double Leaf - When the door has a latch	3095mm (@1050mm width)x2
Double Leaf - Unlatched	3045mm (@1050mm width)x2

FD60 Sizes

Door leaf size max height per leaf	FD60 Max door leaf width
Single Leaf - When the door has a latch	1384mm (@2441mm Height)
Single Leaf - Unlatched	1359mm (@2685mm Height)
Double Leaf - When the door has a latch	1142mm (@2300mm Height)x2
Double Leaf - Unlatched	1117mm (@2336mm Height)x2
Door leaf size max width per leaf	
Single Leaf - When the door has a latch	3050mm (@825mm width)
Single Leaf - Unlatched	3000mm (@825mm width)
Double Leaf - When the door has a latch	2850mm (@825mm width)x2
Double Leaf - Unlatched	2800mm (@825mm width)x2

For double action doorsets & PyroSuite doorset sizes, please contact our technical sales team.